

SERIES R303

2x2 and 2x4
Pre-Wired RetroFit Assembly
For Recessed Troffers

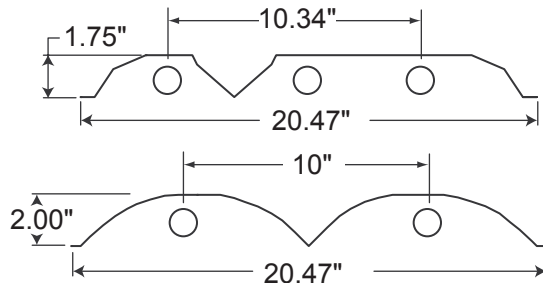
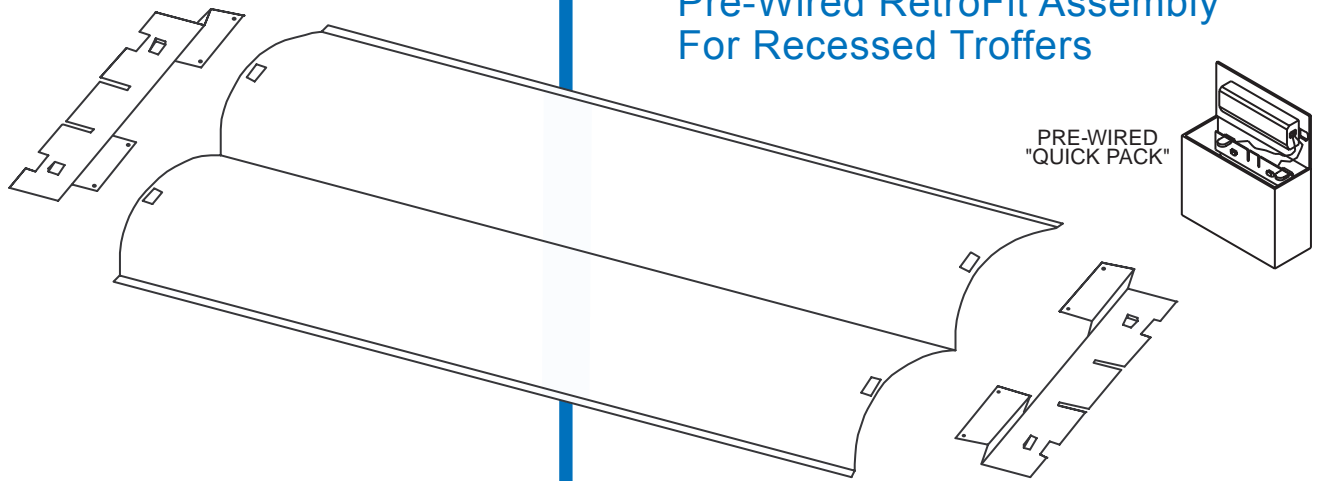

FEATURES:

- PRE-WIRED SOCKET PLATES AND BALLAST ARE SHIPPED IN A "QUICK PACK" FOR EASE OF INSTALLATION
- REDUCES INSTALLATION LABOR
- ELIMINATES THE RISK OF LOST COMPONENTS
- COMPUTERIZED DESIGN IMPROVES LIGHT DISTRIBUTION
- TOOL FREE REFLECTOR INSTALLATION
- STANDARD STYLES INCLUDE 2X2 AND 2X4 SIZES IN 2 OR 3 LAMP VERSIONS
- POST PAINTED HIGH REFLECTANCE POWDER COAT FINISH

UNION MADE IN THE USA.

ORDERING:

NOMINAL SIZE	LAMPS	CATALOG NUMBER
2' X 2'	2-FO17	R303-224T8
2' X 4'	2-FO32	R303-248T8
2' X 2'	3-FO17	R303-324T8
2' X 4'	3-FO32	R303-348T8

INSERT VOLTAGE AT END OF CATALOG NUMBER

NOTES:

1. REFLECTORS SHIPPED 10 PER CARTON
2. PRE-WIRED "QUICK PACK" SHIPPED 10 PER MASTER PACK

MANUFACTURING
1715 KIBBY ROAD - MERCED - CALIFORNIA - 95340
(209) 723-9120 - FAX: (209) 723-9131

SALES OFFICE
14722 WICKS BLVD. - SAN LEANDRO - CALIFORNIA - 94577-6718
(510) 667-6950 - FAX: (510) 667-6959

INSTALLATION INSTRUCTIONS

TURN OFF POWER TO THE FIXTURES.

REMOVE LAMPS AND BALLAST COVER.

DISCONNECT BALLAST FROM POWER SUPPLY.

REMOVE AND DISCARD EXISTING SOCKET PLATE AND BALLAST IN ACCORDANCE WITH LOCAL CODES AND REQUIREMENTS.

INSTALL BALLAST BY SECURING TO THE TOP OF EXISTING HOUSING. REMOVE SOCKET PLATES FROM MOUNTING BOX (DISCARD BOX).

SECURE SOCKET PLATES WITH "TEK" SCREWS SO THAT THE LAMPHOLDERS ARE AGAINST THE ENDS OF THE FIXTURE AND CENTERED LONGITUDINALLY

CONNECT BALLAST LEADS TO POWER SUPPLY (ENSURE BALLAST IS GROUNDED TO FIXTURE).

NOTE: IF THE INCOMING POWER IS END FED, BEND CENTER TAB DOWN TO ALLOW ROOM FOR WIRES TO PASS.

SNAP R303 REFLECTOR INTO TABS LOCATED ON SOCKET PLATES.

CLEAN REFLECTOR, INSTALL LAMPS AND TURN ON POWER.

NOTE

All fixtures must be installed,
wired and grounded in accordance
with the National Electric Code and all
other applicable codes.

!!! WARNING !!!

RISK OF FIRE OR ELECTRICAL SHOCK. ELECTRICAL PARTS MAY BE DAMAGED WHEN DRILLING OR USING "TEK" SCREWS FOR INSTALLATION OF MOUNTING HARDWARE. CHECK ENCLOSED WIRING AND COMPONENTS. USE CAUTION WHEN DRILLING "TEK" SCREWS INTO A BLIND AREA. TO PREVENT WIRING DAMAGE DO NOT EXPOSE WIRING TO SHARP EDGES.

